

ENDSTATE Summer 2013 US 40 at MD 715 Interchange

Widens US40
bridge to 4 lanes;
Adds 2nd lane to
WB 40 ramp

Adds lane to EB
US40 ramp

3 outbound
lanes MD715

Adds 2nd lane
to WB 40
ramp

Adds 2 exit
lanes onto
MD715

4 thru lanes at
MD7 to SB
MD715

3 inbound
lanes MD715

Adds exit
lane to
EB US40

- Construction lane closures will
avoid peak hours
- Pay attention to traffic controls

BENFIELD
ELECTRIC

WALMART

STACK &
STORE

US 40 WB
US 40 EB

MD 715 NB
MD 715 SB

ABERDEEN
BUILDING
PRODUCTS

ABERDEEN
PROVING
GROUND

TO ABERDEEN PROVING GROUND

LEGEND
- EXISTING TRAFFIC FLOW
- PROPOSED TRAFFIC FLOW
- PROPOSED IMPROVEMENT AREA
- PROPERTY LINE
- PROPOSED RIGHT OF WAY
- STREAM
- ECCC REMOVE FLOWOUT

URS

SHA
STATE OF MARYLAND
DEPARTMENT OF TRANSPORTATION
STATE HIGHWAY ADMINISTRATION
HIGHWAY DESIGN DIVISION

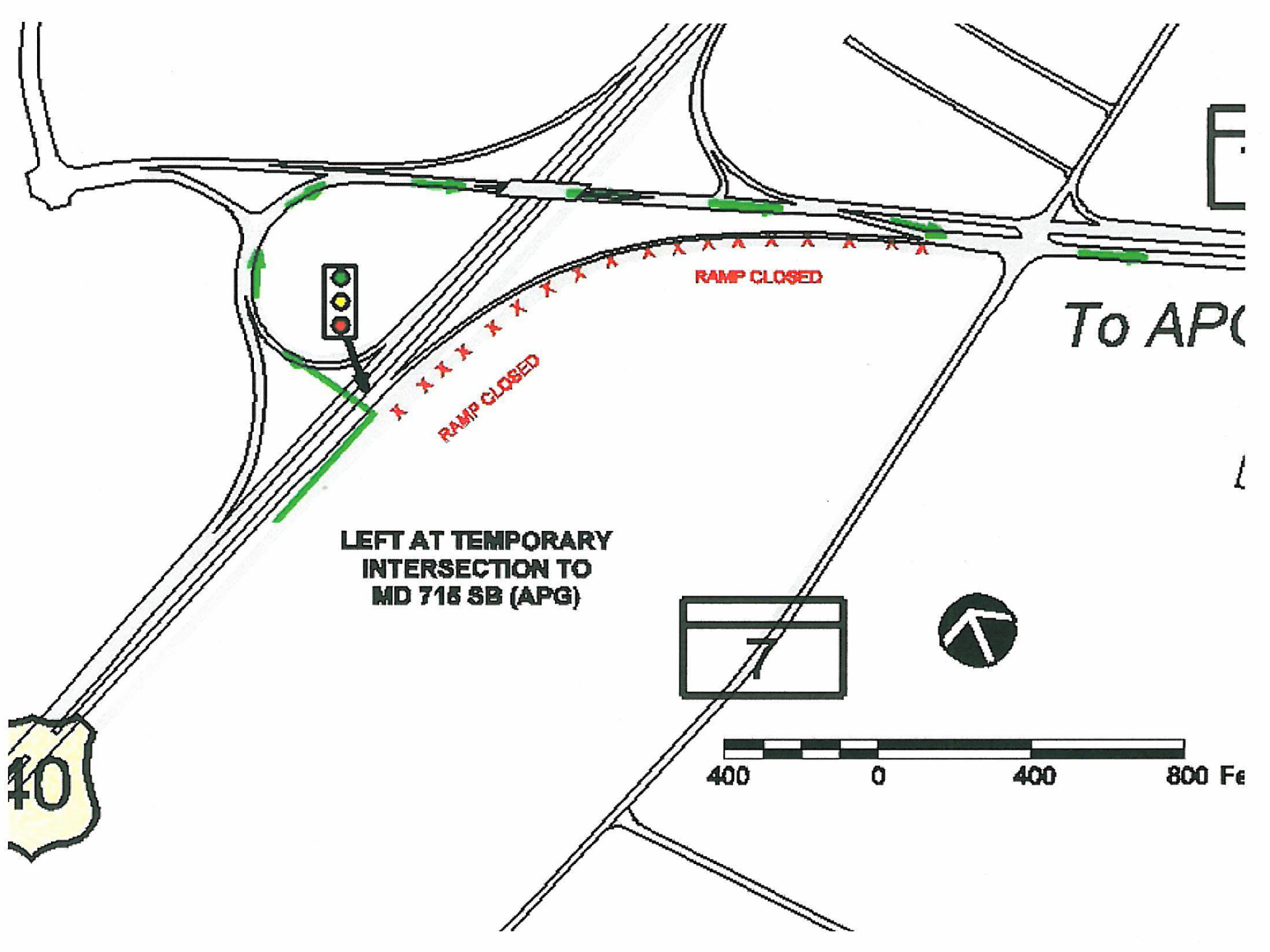

**LEFT AT TEMPORARY
INTERSECTION TO
MD 715 SB (APG)**

RAMP CLOSED

RAMP CLOSED

To APG

400 0 400 800 Fe

40

7

